

MEETS THE EU NORM
UNI EN 1504-2(C)
STANDARDS
PI-MC-IR
PROTECTION OF CONCRETE SURFACE

MEETS THE EU NORM
UNI EN 13813 (CT)
STANDARDS
C60-F15-A9
CEMENTITIOUS SCREEDS

DESCRIPTION

WINPOX CEMENT SL is a three-components, self-leveling, high strength mortar, based on epoxy resins, specially formulated for the preparation of cementitious substrates also if wet. Suitable for thicknesses from 1 to 7 mm.

APPLICATION FIELDS

It's a product developed to allow the leveling of uneven and wet surfaces, which need a vapor barrier of high-strength and thickness and where the subsequent treatment of even very sensitive products is required. It can be used also as a primer for cycles which need finishes in epoxy, polyurethanes or epoxy-polyurethanes resins, for the treatment of flooring, even if industrial.

It can be coated with all the liquid membranes of the range WINKLER, with WFZ5 WINFLEX - CEMENT and WINFLEX-CEMENT SUPER, with cementitious adhesives as ROYAL SUPER SP, with the waterproof adhesive BOND CEMENT, with ROYA FAST for fast bonding and with the waterproofing adhesion promoter for balconies, terraces and bathrooms WINGRIP BITUMINOSO.

When used with the primer UNIBAR FORMULA and polyurethane finishing WINPAINT, it composes a cycle of exceptional strength for finishing industrial and civil floors, also for vehicular traffic, both indoors and outdoors.

PREPARATION OF SUBSTRATE

Surfaces should always be prepared by shot blasting or scarifying and must be free from dust and loose, inconsistent or contaminated layers by demonstrating a tear resistance of not less than 1.5 MPa.

To ensure continuity in the corners, use WINPOX CEMENT TIXO to create coves. Make recoating with WINPOX CEMENT SL on straight, precise lines and preferably perfectly alongside the share-out joints of the cement floor. Tape the already hardened surface to prevent unaesthetic overlaps. Apply at temperatures between +5°C and +35°C.

ADVICES

Do not add ANY additive nor water.

Do not use the product if the packaging is damaged.

Sanding before over-applying other products.

PREPARATION OF PRODUCT

Put component B together with component A in a clean bucket. Mix thoroughly (with a low-speed drill) avoiding incorporating air bubbles, until getting a homogeneous mixture. Then slowly add component C (Mix of selected binders and aggregates), continuing to mix, until a lump-free mixture is obtained.

APPLICATION

Wet the substrate, apply the product by trowel or a straightedge tool to favour levelling. Use a spiked roller to eliminate any air bubbles inside the product. Apply at temperatures between +5°C and +35°C.

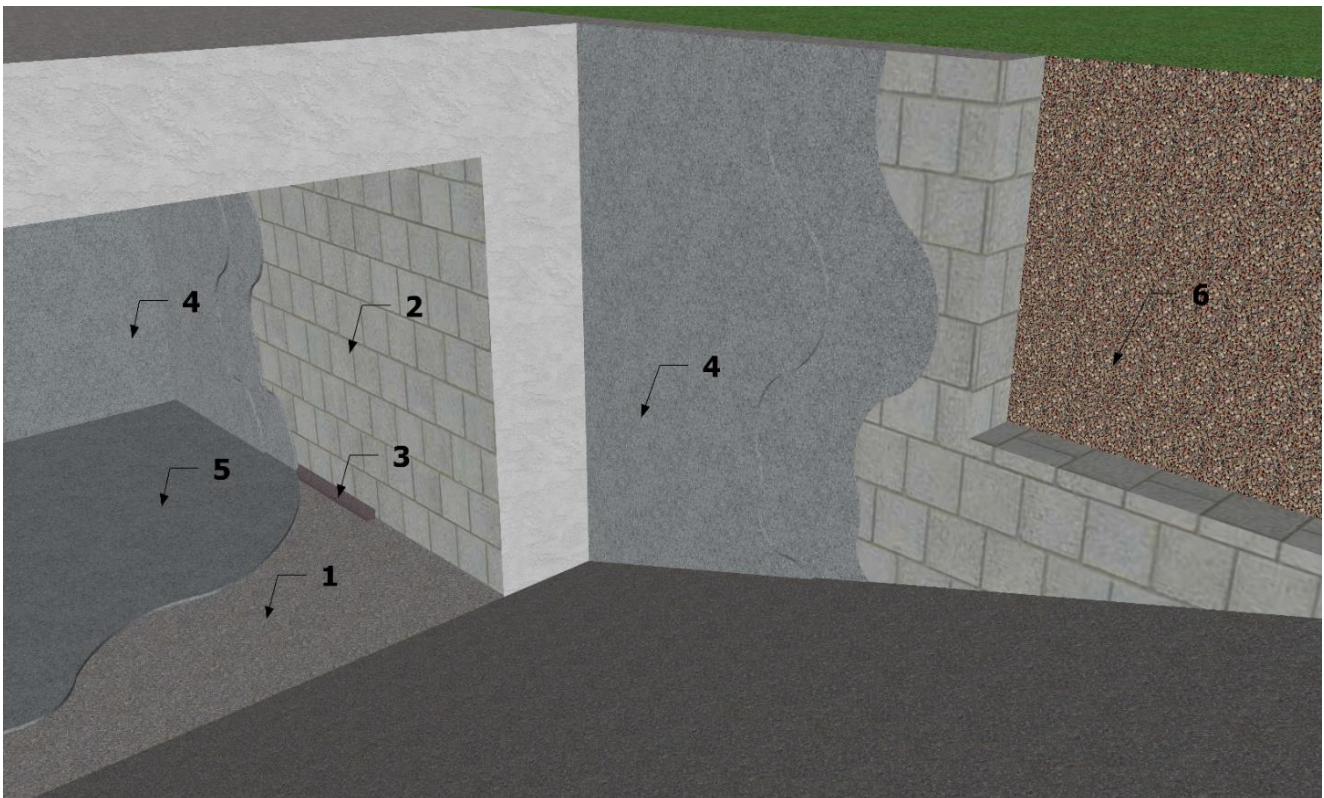

KEYS:

1. Concrete substrate with rising damp;
2. Retaining wall;
3. Cove made using WINPOX CEMENT TIXO;
4. Retaining walls waterproofing with WINPOX CEMENT TIXO in two coats;
5. Floor waterproofing with WINPOX CEMENT SL;
6. Backfill.

APPLICATION EXAMPLES

RIDABLE FLOORS:

WINPOX CEMENT SL, vapor barrier layer

UNIBAR FORMULA, primer

WINPAINT, colored, non-yellowing finish

CONSUMPTION:

WINPOX CEMENT SL: 4/5 kg/m²
UNIBAR FORMULA: 150 g/m²
WINPAINT: 250 g/m² (in two coats)

POOL CYCLE WITH RESIN FINISHING.

WINPOX CEMENT SL, horizontal layer for vapor barrier
WINFLOOR FIX 44 primer
WINPAINT P, colored, non-yellowing finish

CONSUMPTION:

WINPOX CEMENT SL: 2.1 kg/m² per mm of thickness
WINFLOOR FIX 44: 150 g/m²
WINPAINT P: 250 g/m² (in two coats)

POOL CYCLE WITH TILED FINISHING.

WINPOX CEMENT SL, horizontal layer for vapor barrier
BOND CEMENT e/o ROYAL SUPER SP and/or ROYAL FAST (fast adhesive)
WINSTUCCO EPOX.

CONSUMPTION:

WINPOX CEMENT SL: 2.1 kg/m² per mm of thickness
BOND CEMENT e/o ROYAL SUPER SP and/or
ROYAL FAST (Fast adhesive): 3.5 kg/m²
WINSTUCCO EPOX: (See CONSUMPTION on Technical Data Sheet)

WARNINGS

The product must cure perfectly. It is therefore recommended to check that at the time of application, and at least in the following 24 hours, no rising damp occurs. Before over application with other products, check that it is completely dry.

CONSUMPTION

2.1 kg/m² per mm of thickness.

PACKAGING

16 Kg packaging composed by:

Component A	1.20 kg
Component B	2.80 kg
Component C	12.0 Kg

Single packs for a total of 32 Kg composed by:

Component A	2.40 kg
Component B	5.60 kg
Component C	24.0 kg

STORAGE

WINPOX CEMENT SL stored in a cool, dry place in its original sealed packages, has a shelf life of 12 months. The resin has a tendency to crystallization especially if stored at low temperatures. This effect can disappear without influence on the quality, through a low agitation of the separate components by heating them by water bath, up to a maximum of +50°C.

PRECAUTIONS

SAFETY RULES

For information on safety standards, the user must refer to the most recent Safety Data Sheet, drawn up in accordance with the regulations in force, containing the physical, toxicological, and other data relating to the product in use.

ECOLOGY

Do not dispose of the product and/or empty containers in the environment. Consult the most recent Safety Data Sheet for further information on possible disposal.

TECHNICAL FEATURES (average values)

PRODUCT FEATURES

Colour	Grey
Density at +20°C (g/cm ³)	2.10
Texture	Self-levelling mortar
Pot-life at +20°C	25 minutes
Consumption	2.10 kg/m ² /mm
Drying times	
- Dry at touch	5-8 hours
- Carefully walkable	20 hours
- Carefully ridable	24 hours
- Second layer	48 hours
- Completely harden	30 days
Resistance to counter-pressure UNI EN 12390-8) on concrete A/C:0.6	7 bar
Thermal dilation coefficient	< 15.10 ⁻⁶
Elastic module UNI 6556	20.000 MPa

PRODUCT PERFORMANCES ACCORDI TO UNI EN 1504-2

Permeability to water vapor (UNI EN 7783)	S _D >50 m (CLASS III)
Capillary absorption and water permeability (UNI EN 1062-3)	W ≤ 0.0425 kg/m ² .h ^{0.5}
Adhesion strength by direct traction (UNI EN 1542)	≥ 3 N/mm ²

Adhesion strength after 50 freeze-thaw cycles with de-icing salts (EN 13687/1)	$\geq 4 \text{ N/mm}^2$
Fire reaction EN 13501-1	A2-s1,d0

PRODUCT PERFORMANCES ACCORDI TO UNI EN 13813

Compressive strength (UNI EN 13892-2):	
- 24 hours	$30 \pm 5 \text{ N/mm}^2$
- 3 days	$50 \pm 5 \text{ N/mm}^2$
- 28 days	$65 \pm 5 \text{ N/mm}^2$
Flexural strength (UNI EN 13892-2):	
- 24 hours	$5 \pm 1.5 \text{ N/mm}^2$
- 3 days	$9 \pm 1.0 \text{ N/mm}^2$
- 28 days	$17 \pm 2 \text{ N/mm}^2$
Wear resistance (UNI EN 13892-3)	$9 \text{ cm}^3/50\text{cm}^2$

EMISSION OF VOLATILE ORGANIC COMPOUNDS

Parameter	Max. allowed concentration (μm^3)
TVOC after 3 days	≤ 750
TVOC after 28 days	≤ 60

Test performed by the EUROFINS institute according to EN 16516, ISO 16000-3-6-9-11 and ASTM D5116-10, test report N. 392-2018-000081401_G_EN_02

The information contained in this technical data sheet is to the best of our knowledge correct. However, by no means can it be considered a guarantee, as usage, working area and application of the product in accordance with the instructions given and their success in application is beyond our control and is dependent on a number of factors. We decline any responsibility for the improper use of the product as the application recommendations contained herein are to be considered as a general guideline. If at all in doubt, preliminary tests should be carried out. WINKLER S.r.l. reserves the right to modify and up-date said data sheets without prior notice. Clients are kindly requested to verify that they are in possession of the current edition.