

PRODUCT DATA SHEET

SCUDO SYSTEM®

ITEM CODE: SEE DN
ISSUE DATE: 13/02/2025
REVIEW: NO. 12

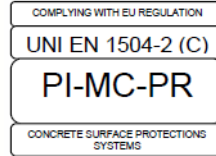

DESCRIPTION OF THE PRODUCT

Elastomeric, resin-based waterproofing paste in water emulsion, formulated with special rubber fillers. It provides long-lasting waterproofing performance and exceptional resistance to puncture. The product ensures excellent durability, elasticity, and long-term impermeability. Formulated by WINKLER Research & Development laboratories.

APPLICABLE REGULATIONS

SCUDO SYSTEM® complies with following standards and certifications:

- **UNI EN 1504-2:** Concrete surface protection systems.
- **IAPMO UES ER-711:** Performance certification for liquid-applied waterproofing products, including applications in contact with the ground.
- **EC1 PLUS (EMICODE):** Certification for construction products with very low emissions of volatile organic compounds (VOC) and semi-volatile organic compounds (SCOV).

FIELDS OF USE

Product designed for the waterproofing of retaining walls, foundations, and concrete structures, Provides strong adhesion to concrete, brick, masonry, and wood surfaces.

SURFACE PREPARATION

Thoroughly clean the surface to remove salts, oils, grease, loose or friable particles, and any foreign or non-adherent substances.

WARNING

- Do not add any additives.
- Do not use the product if the packaging is damaged.
- Do not add any water or solvents.

PRECAUTIONS

Before applying on concrete, ensure the substrate is fully cured (typically 28 days after casting) and free of condensation. Check for hidden moisture in the support to prevent scaling or superficial blisters caused by vapor pressure. Do not apply **SCUDO SYSTEM**® on frozen surfaces or when precipitation, fog, or frost is imminent. After application, protect the product from any form of water (liquid, vapor, or ice) for at least 24 hours, after which it achieves full waterproofing. Wait 4 to 7 days before backfilling.

Apply at temperatures between +5°C and +35°C.

APPLICATION

The product is ready to use and can be applied with a single coat using a metal trowel or by spraying.

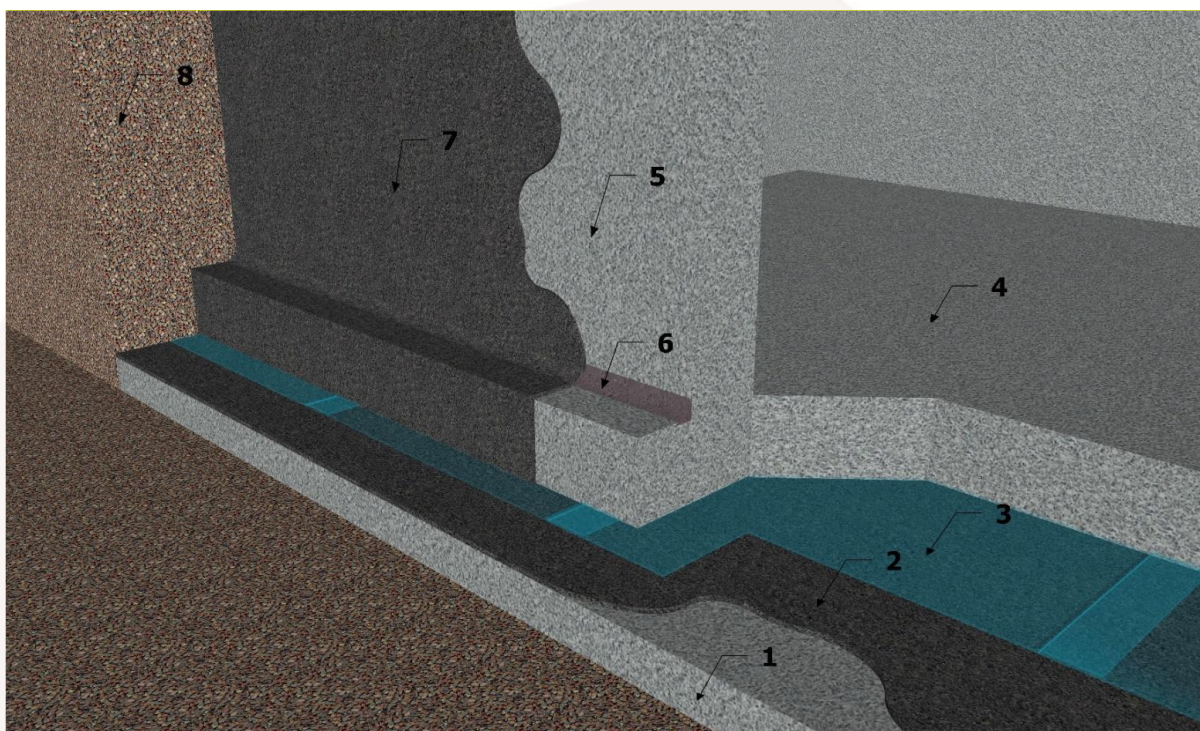

LEGEND:

1. Lean concrete
2. Screed waterproofing – **SCUDO SYSTEM**®
3. Desolarizing layer
4. Foundation
5. Backfill wall
6. Cove – **WR07-FIBROWIN TIXOTROPICA**
7. **SCUDO SYSTEM**®
8. Backfill

CONSUMPTION

Total consumption: 2.8-3.3 kg/m²

Vapour barrier: 3-3.3 kg/m²

PACKAGING

20 kg buckets

STORAGE

The product in its original and undamaged packaging, can be stored for up to 12 months. Store at temperatures between +5°C and 35 °C. The product is not frost-resistant.

SAFETY INSTRUCTIONS

PRECAUTIONS

For safety information, the user must refer to the latest Safety Data Sheet (SDS), prepared in accordance with applicable regulations. The SDS contains detailed information on the physical, toxicological, and safety characteristics of the product.

DISPOSAL AND ENVIRONMENTAL PRECAUTIONS

Do not release the product or empty containers into the environment. For detailed disposal instructions, refer to the most recent Safety Data Sheet (SDS).

TECHNICAL FEATURES (average value)

FEATURES	STANDARD	RESULTS
Appearance	-	Paste
Colour	-	Black
Specific gravity at 20°C	UNI EN ISO 2811-1	1.22 ± 0.01 g/cm ³
Solid content	UNI EN 8490-4	72 ± 1%
pH	UNI EN ISO 3251	9 ± 1
Brookfield viscosity ay 20°C	UNI EN 8490	40.000 ± 3.000 cps

OPERATIONAL PRODUCT PERFORMANCES

Testing Institute: M. MASINI S.r.l. – Test and Research Institute

Test Report: No. 1367-2008

FEATURES	STANDARD	RESULTS
Adhesion test – Concrete	ASTM D 903	Average value: 1.62 MPa Important note: <i>Detachment occurred at the support, not the product</i>
Durability	UNI EN 13251 App. B	Passed, $\geq 80\%$
Water Impermeability	UNI EN 1928	Passed, ≥ 60 kPa (up to 400 Kpa)
Resistance to static loading- Puncture	UNI EN 12730	Passed, ≥ 15 kg
Resistance to negative pressure	UNI 8298-8	2 bars

HARDENED PRODUCT FEATURES ACCORDING TO UNI EN 1504-2

FEATURES	STANDARD	RESULTS
Adhesion strength	UNI EN 1542	≥ 1.5 N/mm ²
CO ₂ permeability	UNI EN 1062-6	$S_D > 50$ m
Water vapour permeability	UNI EN 7783	$S_D > 50$ m (Classe III)
Capillary absorption and water permeability	UNI EN 1062-6	$W < 0.1$ kg/m ² .h ^{0,5}
Impact resistance	UN EN ISO 6272-1	≥ 20 N.m

FEATURES OF THE HARDENED PRODUCT

FEATURES	STANDARD	PERFORMANCE AFTER 14 DAYS CURING	PERFORMANCE AFTER 2 YEARS IN CONTACT WITH MOIST SOIL
Tensile strength	ASTM D 2370	≥ 140 psi	≥ 110 psi
Elongation	ASTM D 2370	≥ 85%	≥ 100%
Shore hardness	ASTM D 2240	30	30
Water absorption	ASTM D 472	≤ 8%	≤ 10%

VOLATILE ORGANIC COMPOUNDS EMISSION

PARAMETER	MAX. ALLOWED CONCENTRATION ($\mu\text{g}/\text{m}^3$)
TVOC after 3 days	≤ 750
TVOC after 28 days	≤ 60

Test performed by the EUROFINS Institute according to EN 16516, ISO 16000-3/6/9/11 and ASTM D5116-10. Test report n. 392-2017-00404102_G_EN_02.

The product complies with the requirements of Directive 2003/53/EC.

PRODUCT FOR PROFESSIONAL USE ONLY

DISCLAIMER AND LEGAL NOTICE - WINKLER

The information and instructions contained in this Technical Data Sheet are prepared on the basis of WINKLER's best technical and application knowledge and are provided for guidance only. However, since WINKLER cannot directly control site conditions or the execution of works, these indications are in no way binding on WINKLER.

The data provided do not exempt the purchaser from the responsibility of verifying, through practical tests and comprehensive applications, the suitability of the product for the intended use and of determining whether it is appropriate for the desired application; the user assumes all responsibility arising from its use. The customer is also responsible for verifying that this Technical Data Sheet is valid for the batch of product of interest and that it has not been superseded by later editions. The updated Technical Data Sheet is available on WINKLER's official website.

The contents of this Technical Data Sheet may be reproduced in other project documents, but the resulting document may under no circumstances replace or supplement the Technical Data Sheet in force at the time of application of the WINKLER product. Any alteration of the text or conditions contained in this Technical Data Sheet or derived from it releases WINKLER from any liability. WINKLER reserves the right to make technical changes of any kind to its products and/or Technical Data Sheets without notice. This revision cancels and replaces all previous ones.